

# G413X

# Setup Guide

Telkom

Follow the below steps and we will automatically connect you to the internet. Or call 10210 for consumer support, and 10214 or 10217 for business support, 7am to 9pm.

If you have a LTE service, view balance and recharge using:

📞 USSD \*180#

📱 MyTelkom app

🌐 [www.telkom.co.za](http://www.telkom.co.za)

## If you have a Fibre service

### 01



**A.** Connect the yellow Ethernet cable supplied with your router to the WAN port on the back of your router.

**B.** Connect the other end of the Ethernet cable into a LAN port on the Fibre (ONT) box.



### 02



- A.** Connect the power connector of the power supply to the power socket at the back of the router.
- B.** Plug the power supply into the wall outlet and switch the wall outlet on.
- C.** Press the power button on the back of the router and allow roughly 1 min for the router to fully boot up.

**FOR FIBRE:** Internet light should be green  
**FOR LTE:** Mobile signal strength lights should light up and the Internet light should be green

**D.** Once hardware setup is complete, if you still have "no internet" access after 5 min, Please phone 10210 for assistance.

## If you have a LTE service

### 01



**A.** Locate the SIM card slot on the back of the router.

**B.** Slide the SIM card into the slot with the gold contact points facing upwards and the cut facing towards the router

**C.** Gently press the SIM card into the slot until you hear a click.

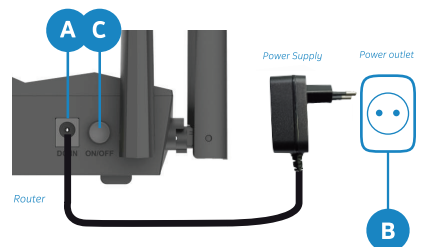
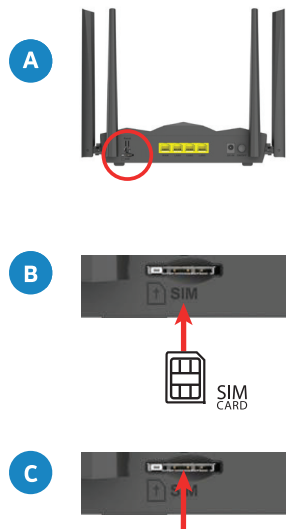

# Package Content

A



G413X Router

B



Power Supply

C



RJ-45 Ethernet Cable

D



Quick Install Guide

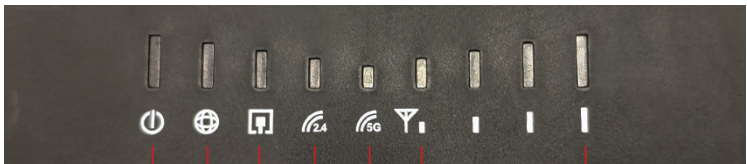

Power



Internet



LAN



Wi-Fi Bands



2.4Ghz & 5Ghz



Mobile signal strength

**Please contact your Internet Service Provider for assistance if:**



The Mobile signal lights stay off after booting the router up with a SIM card inside



The Internet light stays off after connecting the ONT to the WAN port on the router

## Router Wall Mounting Guide

Drill Here (13 cm apart) to mount your router to the wall  
Use screws of up to 4mm (head radius)