

WIRELESS G

Viewing your Wireless Password



This document will detail how to view your Wireless Password on the DIR-600.

If you have forgot your Wireless Encryption Key and or Pre-Shared Key this document is for you.

1. First you will need a computer/laptop to be connected to one of the LAN Ethernet ports.

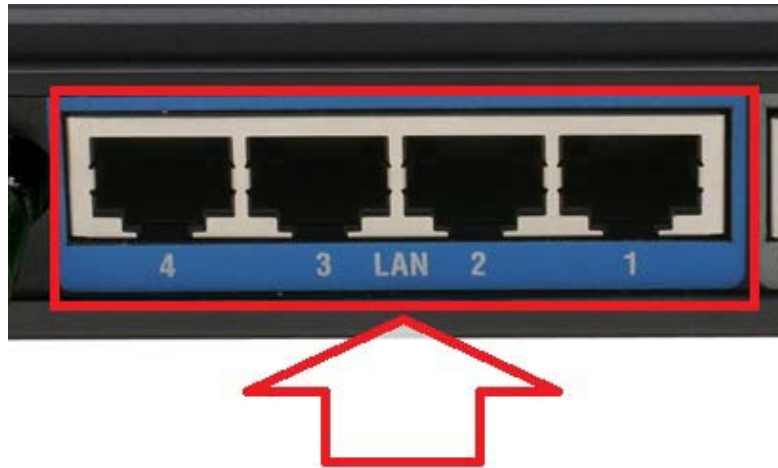

NOTE: If you are going to change your Wireless Encryption Key, **DO NOT** perform this over a Wireless connection, connect your computer/laptop to a LAN Port.

2. Proceed to open an Internet Browser and login to the DIR-600 Web Configuration.

NOTE: Instructions are on the Technical Support Knowledge Base if you are unsure on how to login to the Web Configuration.

3. Click on SETUP > Wireless Setup > Manual Wireless Connection Setup button.

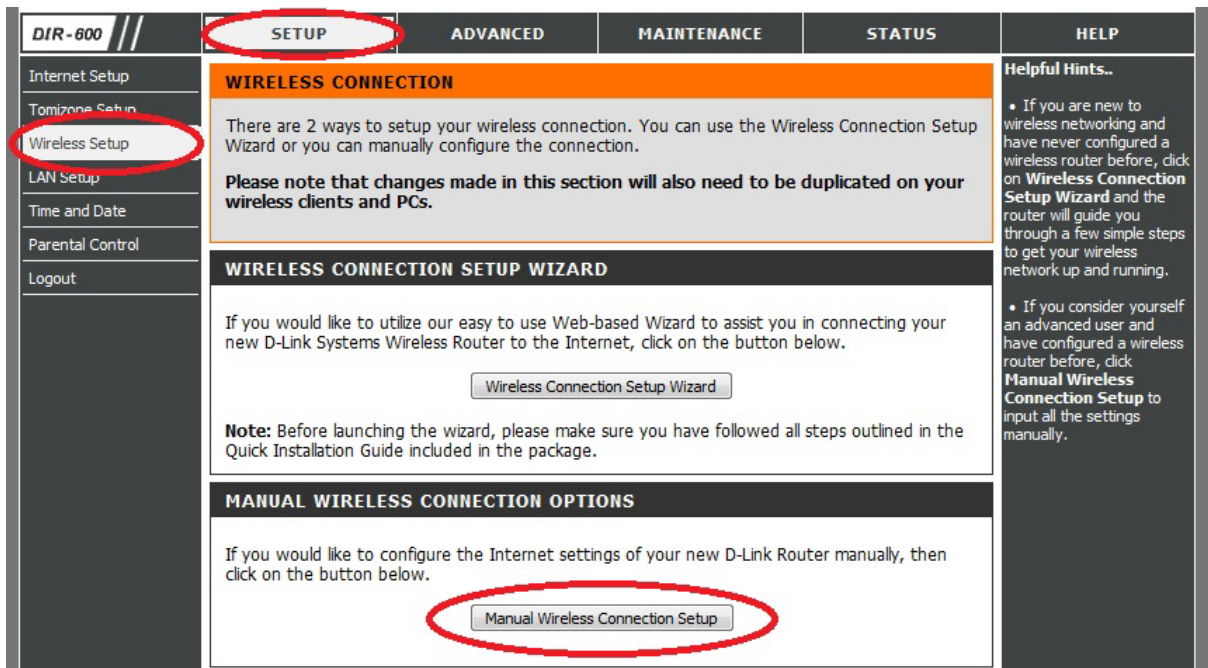

4. Scroll down to the bottom of the page.

5. There are two kinds of Wireless Encryption available: WEP and WPA/WPA2.

6. Refer below to the relevant headings your DIR-600 displays.

WEP:

WEP

WEP is the wireless encryption standard. To use it you must enter the same key(s) into the router and the wireless stations. For 64 bit keys you must enter 10 hex digits into each key box. For 128 bit keys you must enter 26 hex digits into each key box. A hex digit is either a number from 0 to 9 or a letter from A to F. For the most secure use of WEP set the authentication type to "Shared Key" when WEP is enabled.

You may also enter any text string into a WEP key box, in which case it will be converted into a hexadecimal key using the ASCII values of the characters. A maximum of 5 text characters can be entered for 64 bit keys, and a maximum of 13 characters for 128 bit keys.

Authentication :

WEP Encryption :

Default WEP Key :

WEP Key : (5 ASCII or 10 HEX)

Your WEP Key is displayed as per above in clear text.

WPA/WPA2:

WPA ONLY

WPA Only requires stations to use high grade encryption and authentication.

Cipher Type :

PSK / EAP :

Network Key : (8~63 ASCII or 64 HEX)

Your WPA/WPA2 Network Key is displayed as per above in clear text.

NOTE: If you are wanting to change your Wireless Encryption highlight either of the fields and retype a new Wireless Encryption password to use, then proceed to click on the Save Settings button.

IMPORTANT:

If you decide to change your Wireless Encryption password, you will need to remove your existing Wireless Profile or edit it to reflect the new changes.

Please remember to ensure your DIR-600 has the most current firmware version applied. To apply this firmware please refer to the Technical Support Knowledge Base.